



# INSUL FRAME

The Insulframe External Wall system is a lightweight wall panel solution that has been developed for multi-residential buildings and focuses on durability, high acoustic and thermal values, improved weatherproofing and condensation management. At the core of the wall system is a rigid 90mm wall panel, insulated with high-density Rockwool and lined with a breathable fibre cement sheet developed by James Hardie, which acts as an airtight-waterproof barrier to all external weather conditions.

## Structurally Designed

- The Rockwool Panel can be structurally designed to meet any wind load, while being able to support most window sizes without the need for secondary structural steel.

## Improved Weatherproofing

- The External Skin of the Rockwool Panel is a specially developed rigid weatherproof barrier by James Hardie, which creates an air-tight seal to repel water, air and wind but also allowing moisture to escape

## Non-Combustible

- The panel is comprised of materials all deemed non-combustible. It is also rated up to -/60/60 FRL with an internal stud and plasterboard lining.

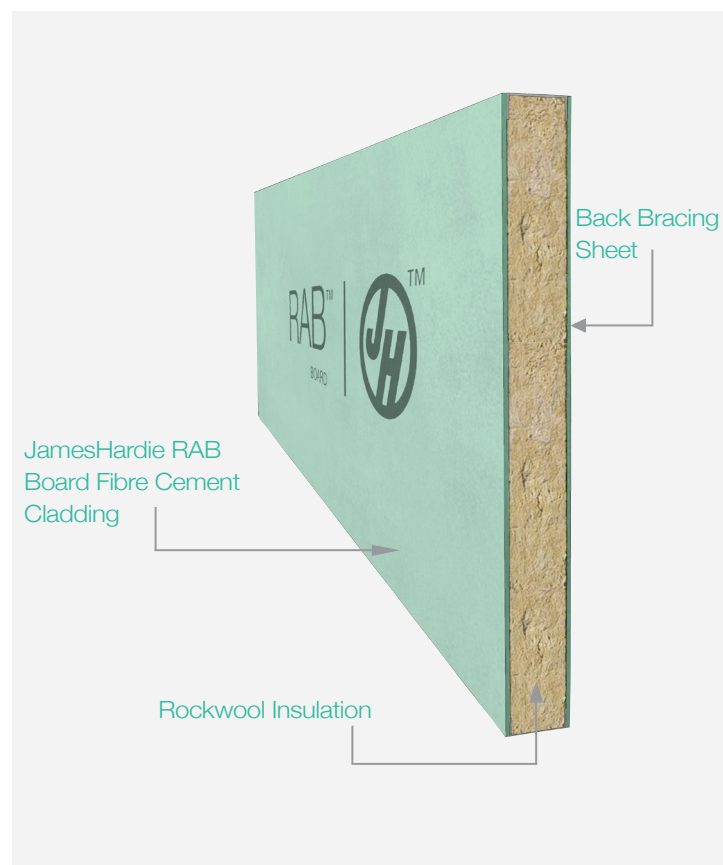

## Technical

- 90mm Thick Panel With Wall System as thin as 150mm thick
- Rockwool Insulation at 80kg/m<sup>3</sup> Density (With Varied density options available)
- Deemed Non Combustible in BCA
- R Value of 2.2 for the 90mm Panel alone which achieves BCA requirements



## High Thermal & Acoustic Properties

- High Density Rockwool Insulation combined with rigid fibre cement linings provides high thermal and acoustic properties, and in turn increases the energy efficiency of each unit.
- High acoustic and thermal values adds value to the development and provides a high level of



## High Durability/Lifespan

- Rigid Weatherproof Air Barrier protects all internal materials from mould and deterioration
- A breathable rigid membrane means condensation is allowed to escape which protects windows and wall linings from rust, mould and deterioration over time.

## Construction Benefits

- Able to completely close-off and seal each floor soon after the slab has been stripped and before cladding is installed, allowing internal services and trades to continue work and improve the flow of the construction program
- External Cladding is able to be completed up to 180 days after panel installation, and is taken off the critical path of the construction program.
- Shop Drawn panels means no cutting or wastage on site, and requires minimal workers on site to complete levels.

## Complete Wall System

Internal Lining (Plasterboard)  
on Furring Channel or Stud

Insuframe Wall Panel

External Battens

External Cladding

