

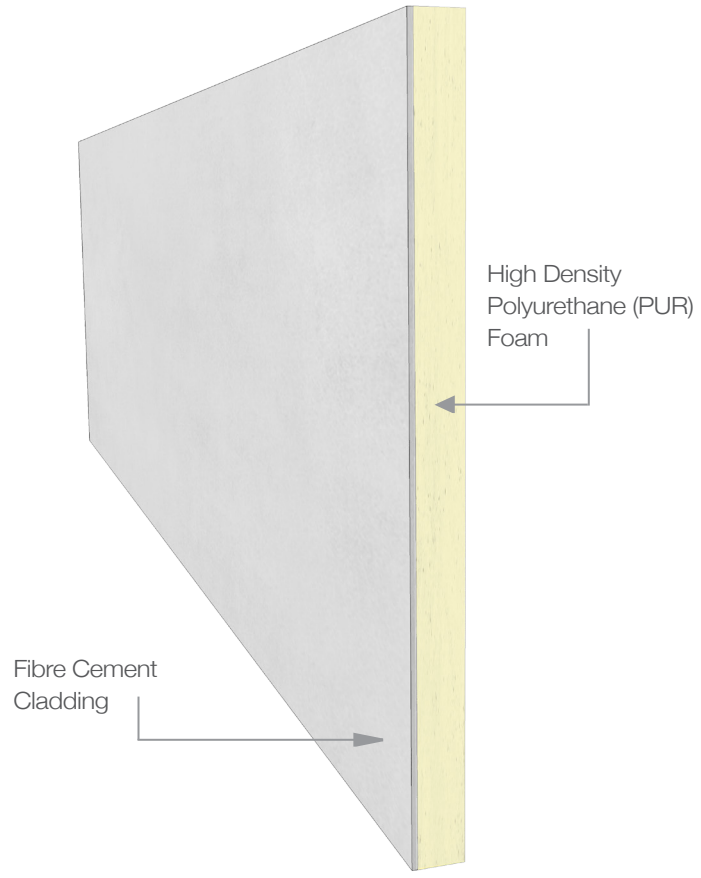

# PURCLAD

PURclad is a thermal building panel designed as an affordable, eco-friendly cladding option. The PURclad panel can be installed with fixings and adhesive to most types of walls in the building industry, including the Fast Fix wall panel. The cement sheeting bonded to the rigid insulation increases the thermal and acoustic properties as well as energy efficiency, whilst adding strength to the wall structure. PURclad also allows for many external finishes variations such as texture rendering, external paint or additional external cladding to achieve your desired style.

## PURCLAD Panel



### Applications

- Applied to Masonry to increase thermal rating
- Applied to Timber/Metal Frame
- Applied to SIPS Wall for increased thermal rating
- Clad over old existing walls to both revamp aesthetics and increase thermal ratings
- Increase thermal values for small sheds,

# PURCLAD Complete Wall System

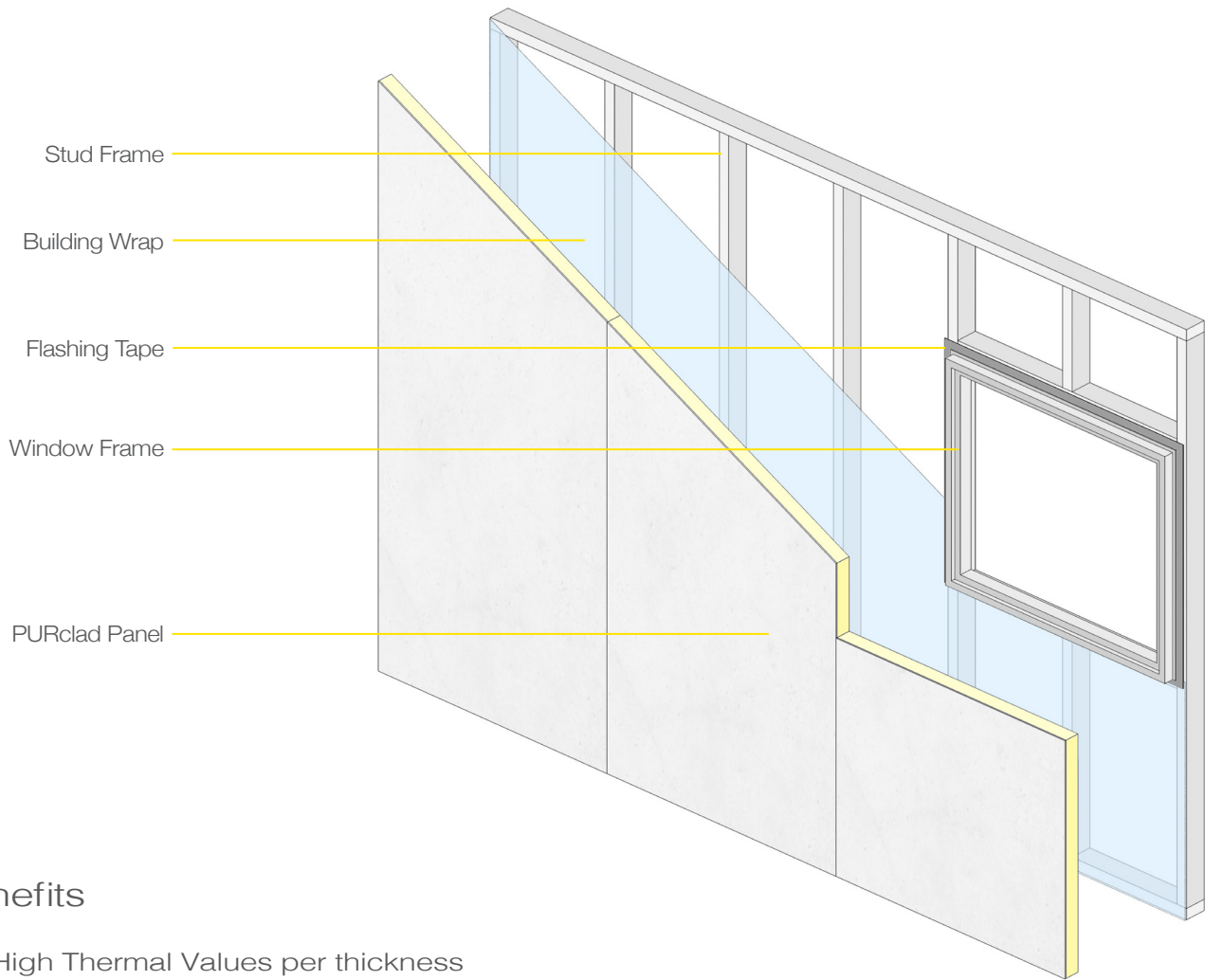

## Benefits

- High Thermal Values per thickness
- Fast and Simple Installation
- Lightweight Building Material
- Water Resistant
- Termite Resistant
- Ready to Finish/Paint or Render
- Affordability

Standard Skin - 6mm Fibre Cement

PUR Density - 42 kg/m<sup>3</sup>

Grade - CFC Free

Compression Strength - 100-300 (kPa)

Closed Cells - 90-95 %

Thickness	Dimensions	R-Value
50	1.2m x 2.4/3m	1.8
75	1.2m x 2.4/3m	2.9
100	1.2m x 2.4/3m	3.9

\* Alternative Sizes upon Request.